



IMPORTANT

- Do not over-tighten any connections or damage may occur.
- Be sure to read instructions thoroughly before beginning installation.

CARE & CLEANING

Your new Product is designed for years of trouble-free performance. Keep it looking new by cleaning it periodically with a soft cloth. The use of harsh chemicals and abrasives on any of the custom finish products may damage the finish and void the product warranty. Please be sure to only use approved cleaners.

SAFETY TIPS

Cover your drain to prevent loss of parts. Be sure to wear eye protection and follow all tool manufacturers safety recommendations.

WAIVER & DISCLAIMER

This waiver-disclaimer is attached to and made a part of the written contract to purchase these products for use in psychiatric and correctional facilities. Such fixtures and products are purchased to reduce the risk of self-imposed death or injury to patients or clients in such facilities, but are NOT represented as able to prevent such death or injury.

Behavioral Safety Products, LLC ("BSP") as the seller and Speakman Company as the manufacturer of these products have not, and will not represent or warrant to the purchaser shown in this contract ("Purchaser") that its fixtures and products will prevent death or injury in any case whatsoever.

BSP and Speakman Company make no express or implied warranty with respect to the preventative quality of its products, but merely represents that the use of such products tends to reduce deaths and injuries by patients or clients who are subject to meticulous screening processes and diligent supervision on the part of the facility housing them.

Purchaser acknowledges the foregoing disclaimer and waives any and all claims against BSP and Speakman Company as to express or implied warranties of fitness for any purpose whatsoever.

TOOLS AND SUPPLIES:

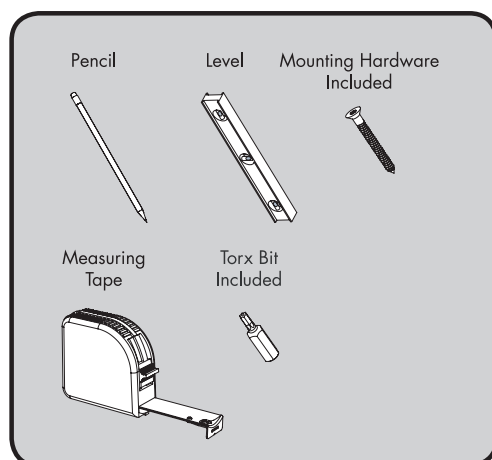

HELPFUL TOOLS AND SUPPLIES:

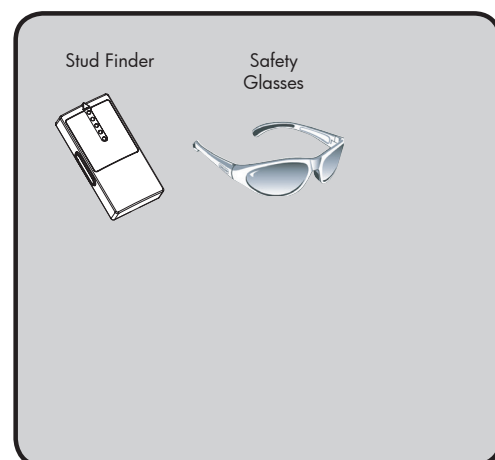

PAGE 3 INSTALLATION INSTRUCTIONS

#SD750, CONTINUED

- 1** Determine desired mounting position of the Ligature Resistant Soap Dispenser. Ensure mounting location is capable of supporting the product in use. Ensure proper mounting structure is present within the wall cavity.

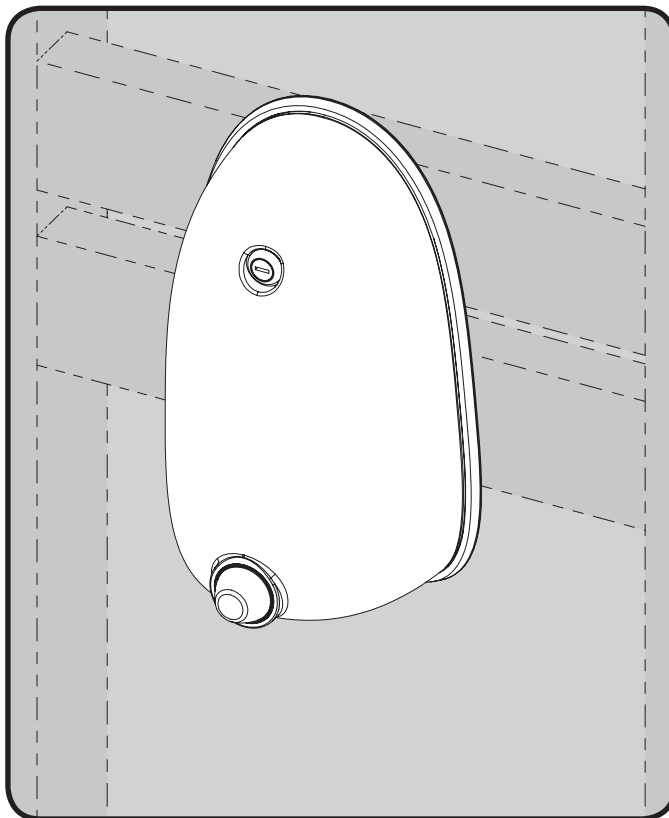

- 2** Open the unit using the Key provided and the front cover will rotate downward.

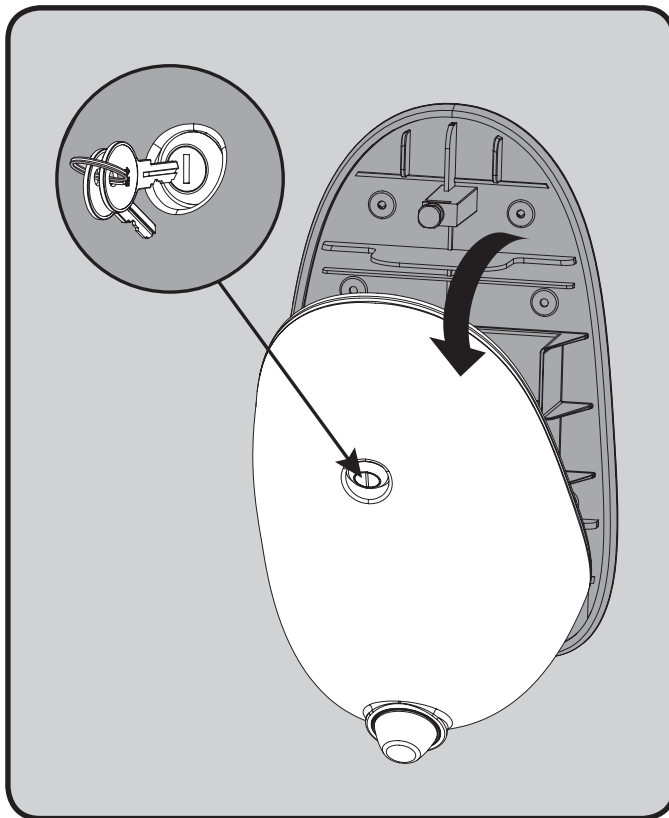

3 Position the product on the wall and mark the hole locations. Eight (8) mounting hole locations are provided. Please select a minimum of four (4) mounting holes based on your site requirements. Recommended mounting holes are highlighted below.

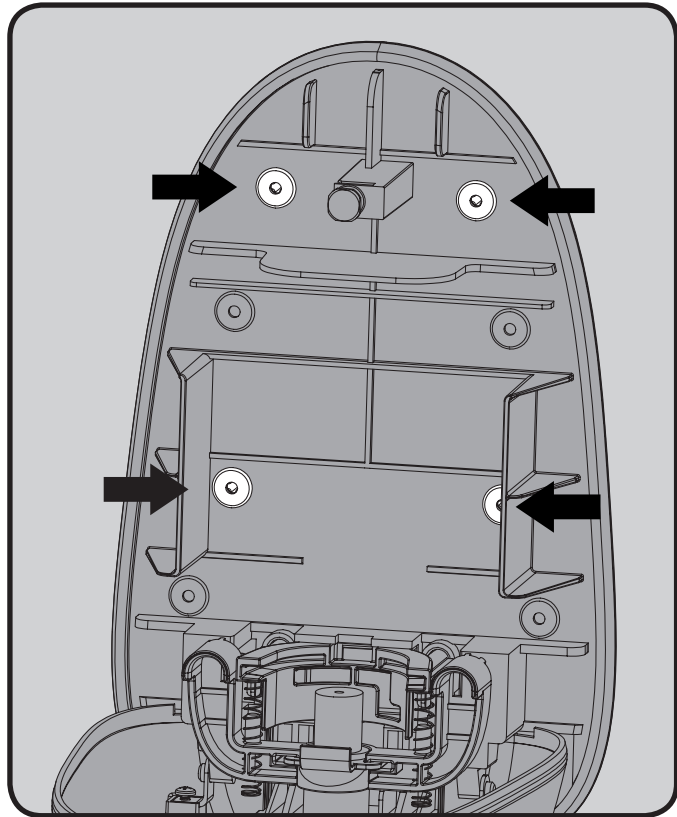

4 Install supplied Mounting Hardware through the four (4) mounting locations using the supplied Torx driver to secure into brace (supplied by installer) or into wall structure.

Note: Mounting Anchors are not included. If your installation requires Mounting Anchors, acquire appropriate screws to go with the anchors.

This will support the Ligature Resistant Soap Dispenser. Ensure the mounting structure and mounting hardware can safely support the product in use.

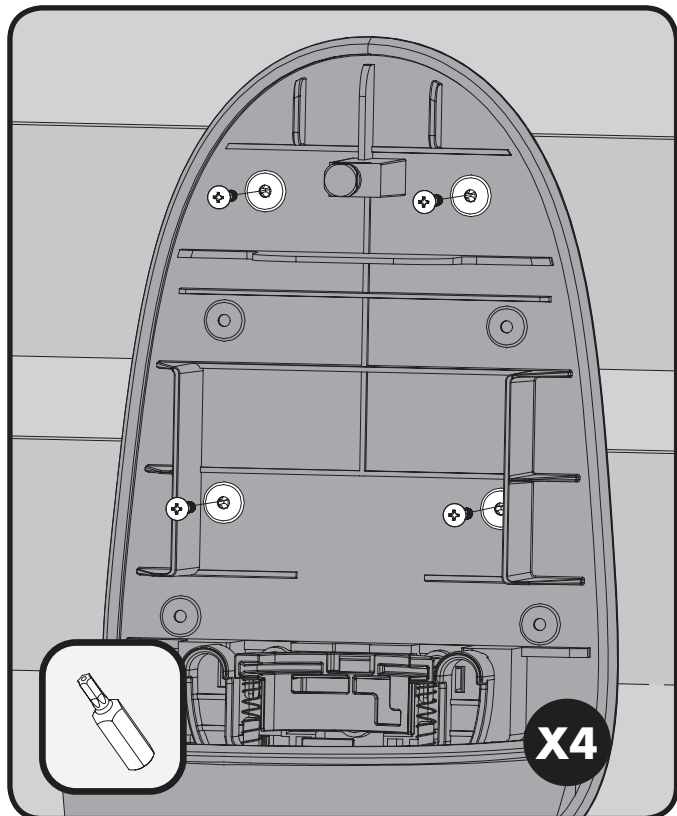

STEP 1: Remove the Red Clip (1).

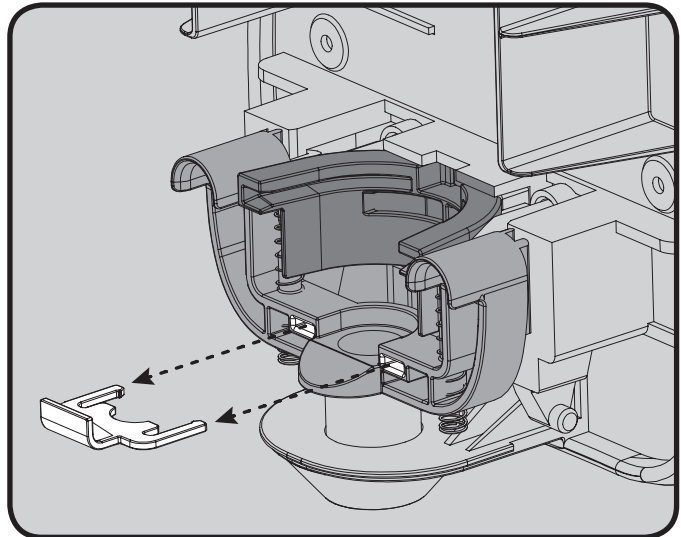

STEP 2: Product is designed to accept GOJO® 1250 mL soap refills. With the bottle inverted as shown, depress Soap Bottle Nipple upward.

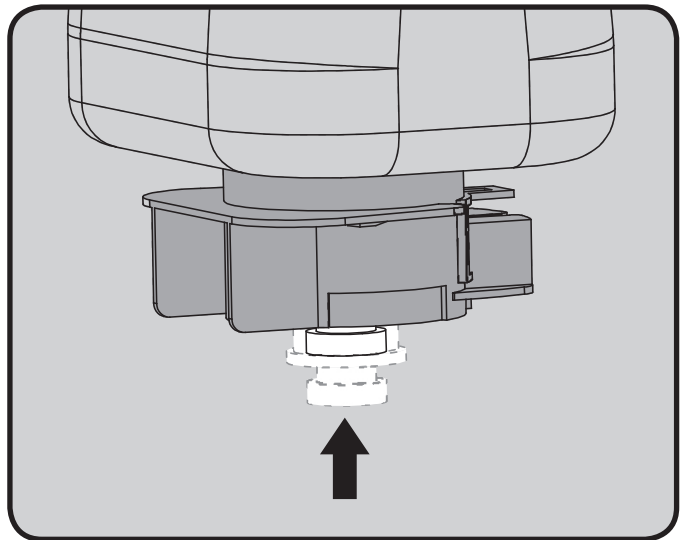

STEP 3: Align Soap Bottle Bracket with slots in Receiver (Blue) (2) and insert. Keeping bottle vertical and allowing Nipple (1) to drop into hole.

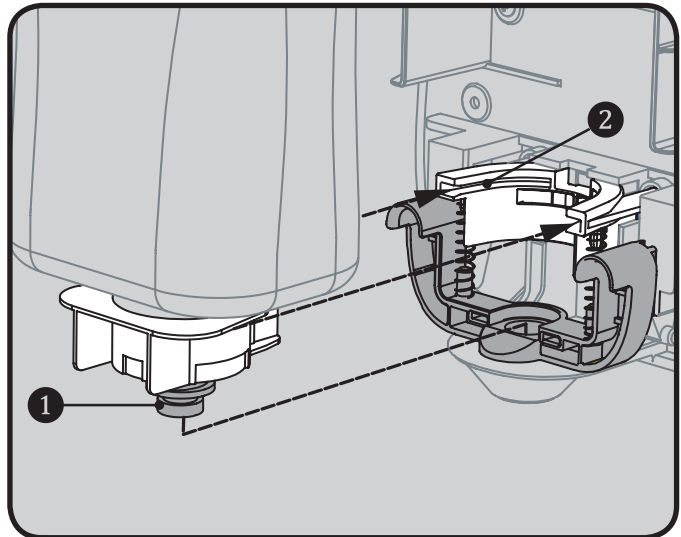

STEP 4: Push Retainer Clip (red) into Yoke Slots (gray).

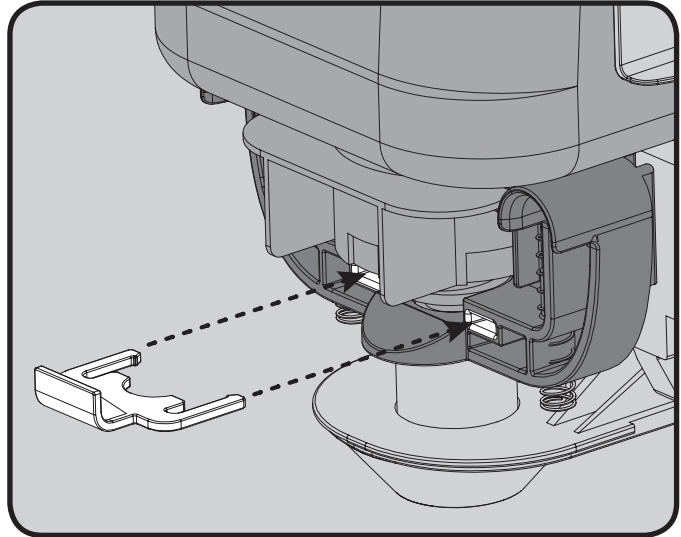

STEP 5: Close the unit and lock with the key. Push the button to activate the soap.

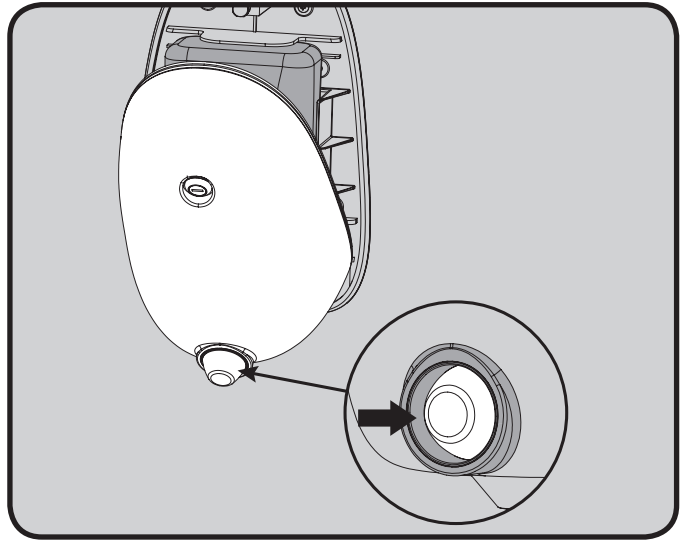

TROUBLESHOOT

If no soap is dispensed as you push the button:

1. Open the unit and remove the soap bottle by reversing the Soap Bottle Installation steps.
2. Depress the Soap Bottle Nipple upward several times.
If Soap begins to flow properly, reinstall Soap Bottle to Dispenser and retest unit.
3. If no soap flows when the Soap Bottle Nipple is depressed, switch to a new soap bottle refill, install and retest.

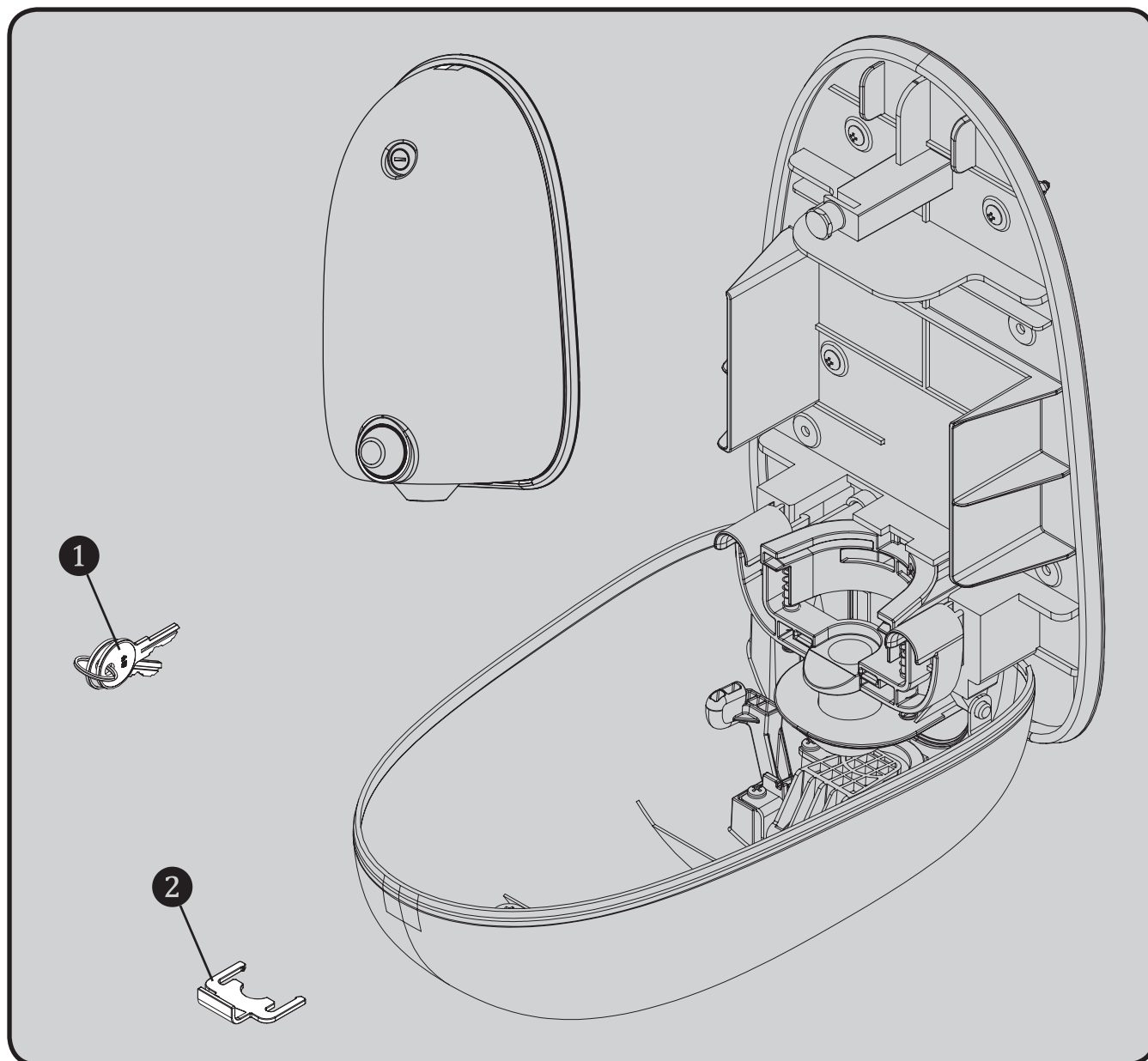

| Item Number | Part Number | Description |
|-------------|--------------|--|
| 1 | RPG44-106407 | Replacement Clip for SD750 |
| 2 | RPG05-106408 | Replacement Keys for SD750 (Two Keys to be Provided) |