



BEHAVIORAL SAFETY

INNOVATION NEVER RESTS

LIGATURE RESISTANT SOAP DISPENSER

#SD750

Installation, Maintenance & Operation Instructions

This heavy-duty metal construction soap dispenser reduces ligature risk normally associated with standard soap dispensers. This ligature resistant product can be wall mounted in any location. The activation allows for easy one hand operation. The unit is designed to fit multiple products allowing choice of different available material options including soap, foaming soap, and anti-bacterial. The front housing contains a key locking device to allow quick access for cartridge replacement. All exposed surfaces are powder coated in a durable white finish. The back-mounting plate has multiple mounting holes to allow various configurations. Overall dimensions are 7-7/8"W x 12-3/8"H flange and 5-1/16"D.

*This product is approved in the NYS Office of Mental Health Patient Safety Standards, Materials and System Guidelines.

Cartridges

- See page 2 for compatible options.

Specifications

- All exterior metal construction
- All exposed finish surfaces are powder coated
- Soap dispenser mounts directly to the wall
- Front cover is secured by mounting lock with positive engagement
- Includes keyed locking device to allow quick access for soap replacement
- Cartridges can be easily replaced
- Flanged edge engages with front cover
- Tamper Resistant Screws used for mounting

Important

- Be sure to read instructions thoroughly before beginning installation.
- Do not over-tighten any connections or damage may occur.

Safety Tips

Cover your drain to prevent loss of parts. Be sure to wear eye protection and follow all tool manufacturer's safety recommendations.



Compatible Cartridges

As currently configured, the SD750 uses Gojo, Purell, and Provon cartridges designed for FMX-12 dispensers.

Hand Soap

- 5161-04** Gojo Luxury Foam Handwash
- 5162-04** Gojo Luxury Foam Antibacterial Handwash
- 5165-04** Gojo Green Certified Foam Hand Cleaner
- 5167-04** Gojo E1 Foam Handwash
- 5169-04** Gojo E2 Foam Handwash with PCMX
- 5182-04** Provon Green Certified Foam Hand Cleaner
- 5185-04** Provon Foaming Handwash with Moisturizers
- 5186-04** Provon Foaming Antimicrobial Handwash with Moisturizers

Hand Sanitizer

- 5091-04** Purell Advanced Hand Sanitizer Green Certified Gel
- 5191-04** Purell Advanced Green Certified Instant Hand Sanitizer Foam
- 5192-04** Purell Advanced Hand Sanitizer Foam
- 5193-04** Purell Advanced Hand Sanitizer E3 Rated Foam
- 5198-03** Purell Advanced Hand Sanitizer Skin Nourishing Foam
- 5199-04** Purell VF PLUS hand Sanitizer Gel

Hair & Body Wash

- 5163-03** Gojo Green Certified Foam Hand, Hair & Body Wash
- 5187-04** Provon Foaming Hair & Body Wash with Moisturizers

Care & Cleaning

Your new Product is designed for years of trouble-free performance. Keep it looking new by cleaning it periodically with a soft cloth and mild soap. The use of harsh chemicals and abrasives on any of the custom finish products may damage the finish and void the product warranty. Please be sure to only use approved cleaners.

Important

If the dispenser is installed in a shower, we recommend lubrication of the lock on a monthly basis, to avoid corrosion in the lock mechanism.

Waiver & Disclaimer

This waiver-disclaimer is attached to and made a part of the written contract to purchase these products for use in psychiatric and correctional facilities. Such fixtures and products are purchased to reduce the risk of self-imposed death or injury to patients or clients in such facilities, but are NOT represented as able to prevent such death or injury.

Behavioral Safety Products, LLC (“BSP”) as the seller and Speakman Company as the manufacturer of these products have not, and will not represent or warrant to the purchaser shown in this contract (“Purchaser”) that its fixtures and products will prevent death or injury in any case whatsoever.

BSP and Speakman Company make no express or implied warranty with respect to the preventative quality of its products, but merely represents that the use of such products tends to reduce deaths and injuries by patients or clients who are subject to meticulous screening processes and diligent supervision on the part of the facility housing them.

Purchaser acknowledges the foregoing disclaimer and waives any and all claims against BSP and Speakman Company as to express or implied warranties of fitness for any purpose whatsoever.

Rough In Dimensions

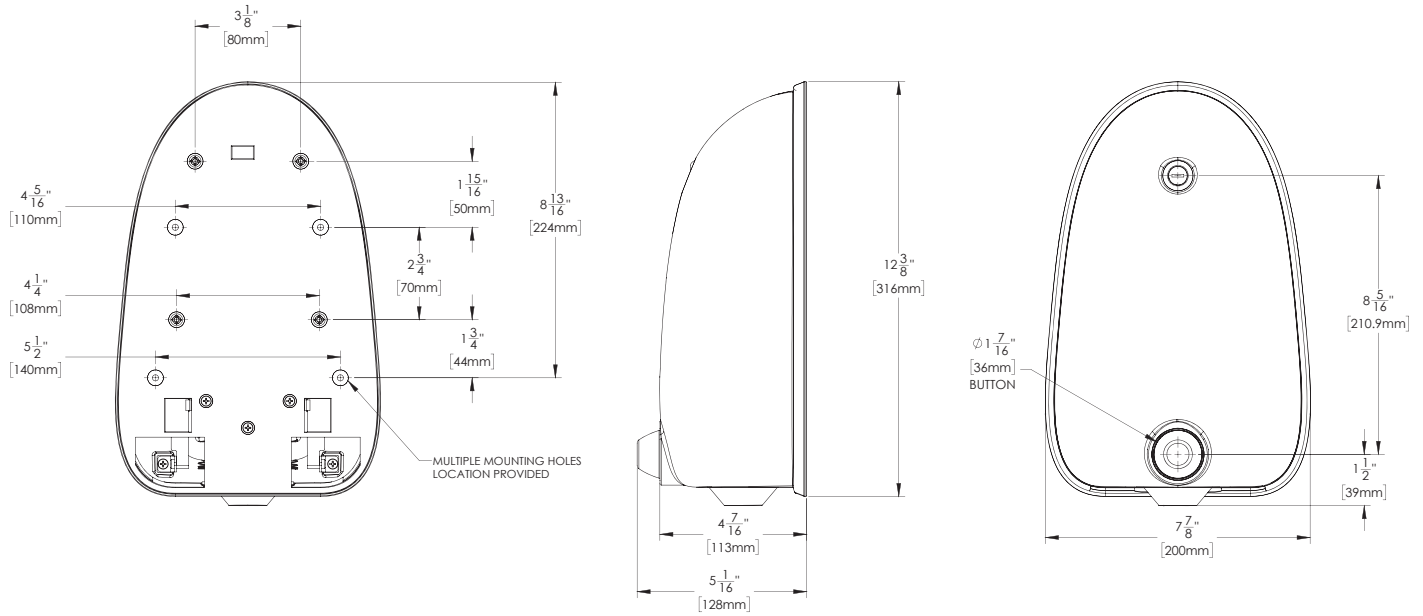

Tools and Supplies

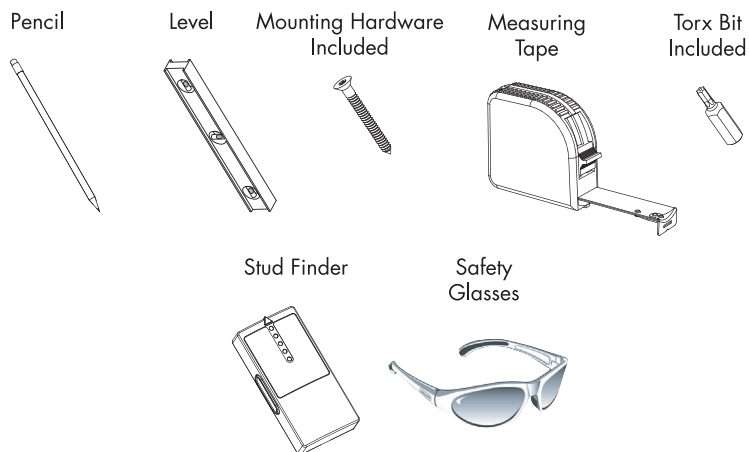



Installation Instructions

1. Determine desired mounting position of the Ligature Resistant Soap Dispenser. Ensure mounting location is capable of supporting the product in use. Ensure proper mounting structure is present within the wall cavity.

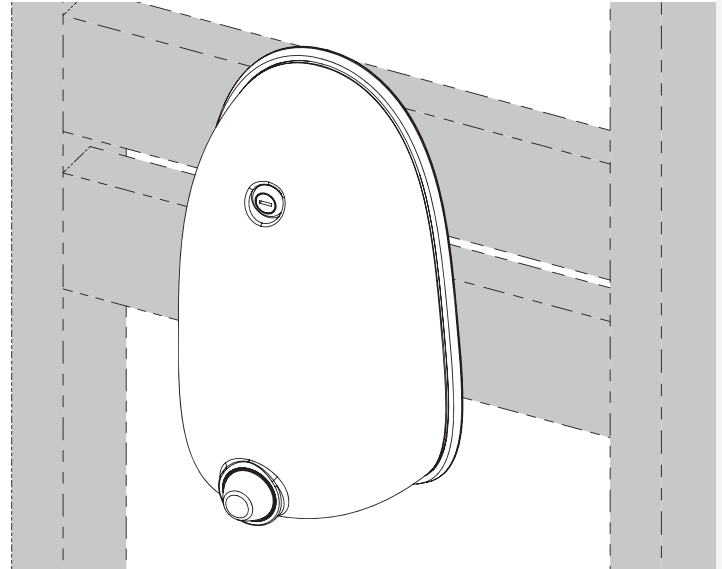

2. Open the unit using the Key provided and the front cover will rotate downward.

Important

If the dispenser is installed in a shower, we recommend lubrication of the lock on a monthly basis, to avoid corrosion in the lock mechanism.

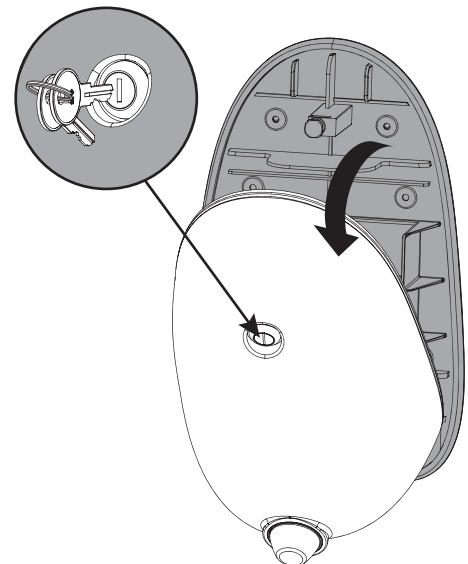



3. Position the product on the wall and mark the hole locations. Eight (8) mounting hole locations are provided. Please select a minimum of four (4) mounting holes based on your site requirements. Recommended mounting holes are highlighted below.

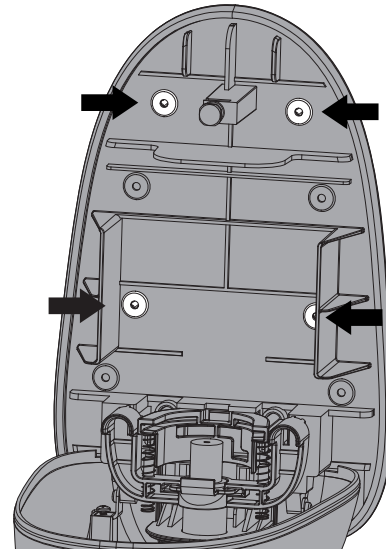

4. Install supplied Mounting Hardware through the four (4) mounting locations using the supplied Torx driver to secure into brace (supplied by installer) or into wall structure.

Note: Mounting Anchors are not included. If your installation requires Mounting Anchors, acquire appropriate screws to go with the anchors.

This will support the Ligature Resistant Soap Dispenser. Ensure the mounting structure and mounting hardware can safely support the product in use.

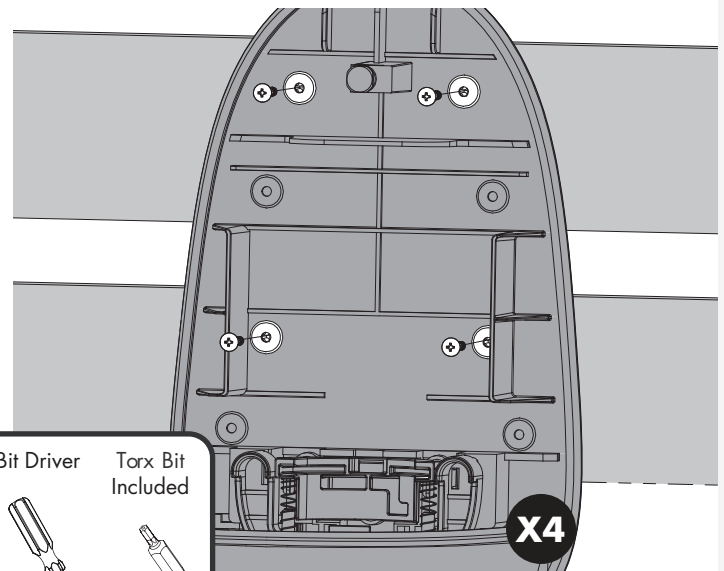

Bit Driver Torx Bit
Included

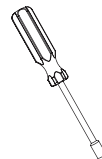

X4



Soap Bottle Installation

1. Remove the Red Clip (1).

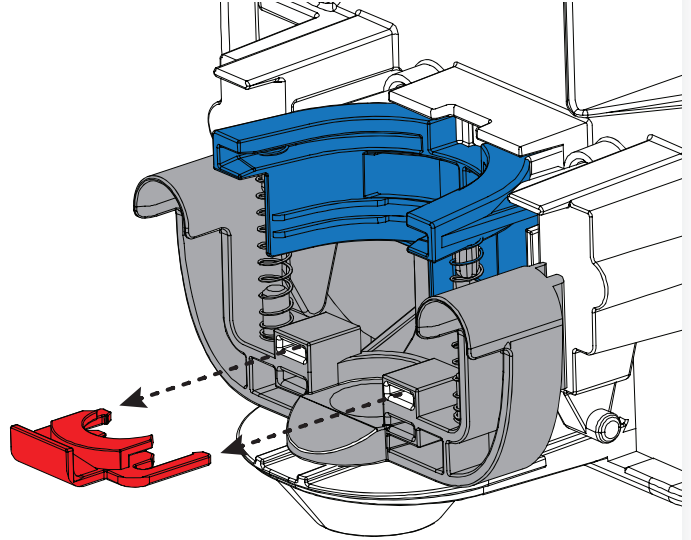

2. As currently configured, product is designed to accept Gojo® or Provon® FMX-12 1250 mL soap refills. With the bottle inverted as shown, depress Soap Bottle Nipple upward.

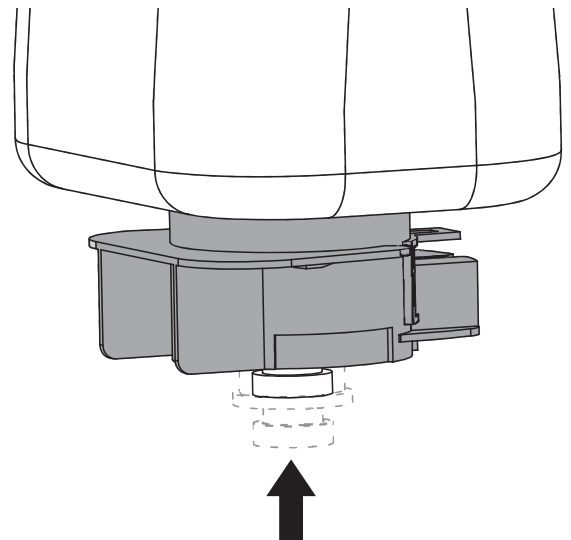



Soap Bottle Installation

3. Align Soap Bottle Bracket with slots in Receiver (Blue) (2) and insert. Keeping bottle vertical and allowing Nipple (1) to drop into hole.

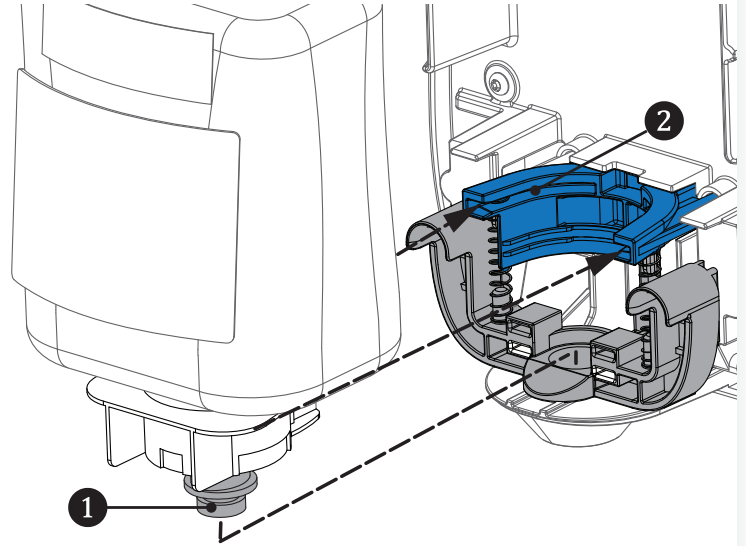

4. Push Retainer Clip (Red) into the **bottom** Yoke Slots (Gray).

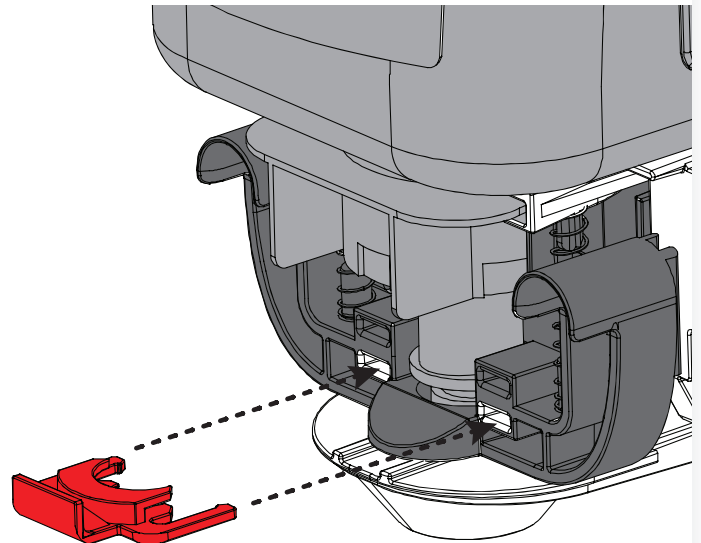



Soap Bottle Installation

5. Close the unit and lock with the key.
Push the button to activate the soap.

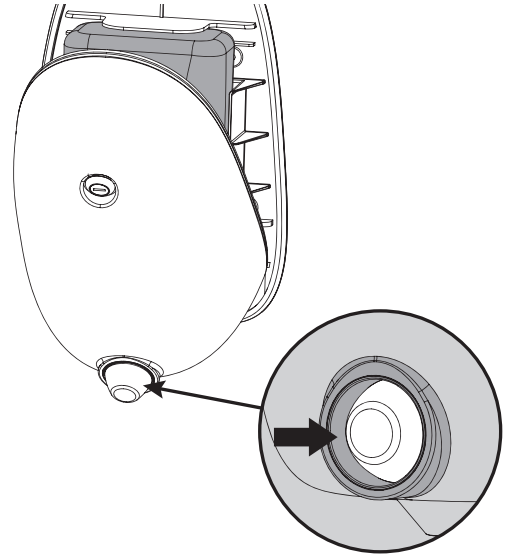

Troubleshoot

If no soap is dispensed as you push the button:

1. Open the unit and remove the soap bottle by reversing the Soap Bottle Installation steps.
2. Depress the Soap Bottle Nipple upward several times. If Soap begins to flow properly, reinstall Soap Bottle to Dispenser and retest unit.
3. If no soap flows when the Soap Bottle Nipple is depressed, switch to a new soap bottle refill, install and retest.



Repair / Replacement Parts

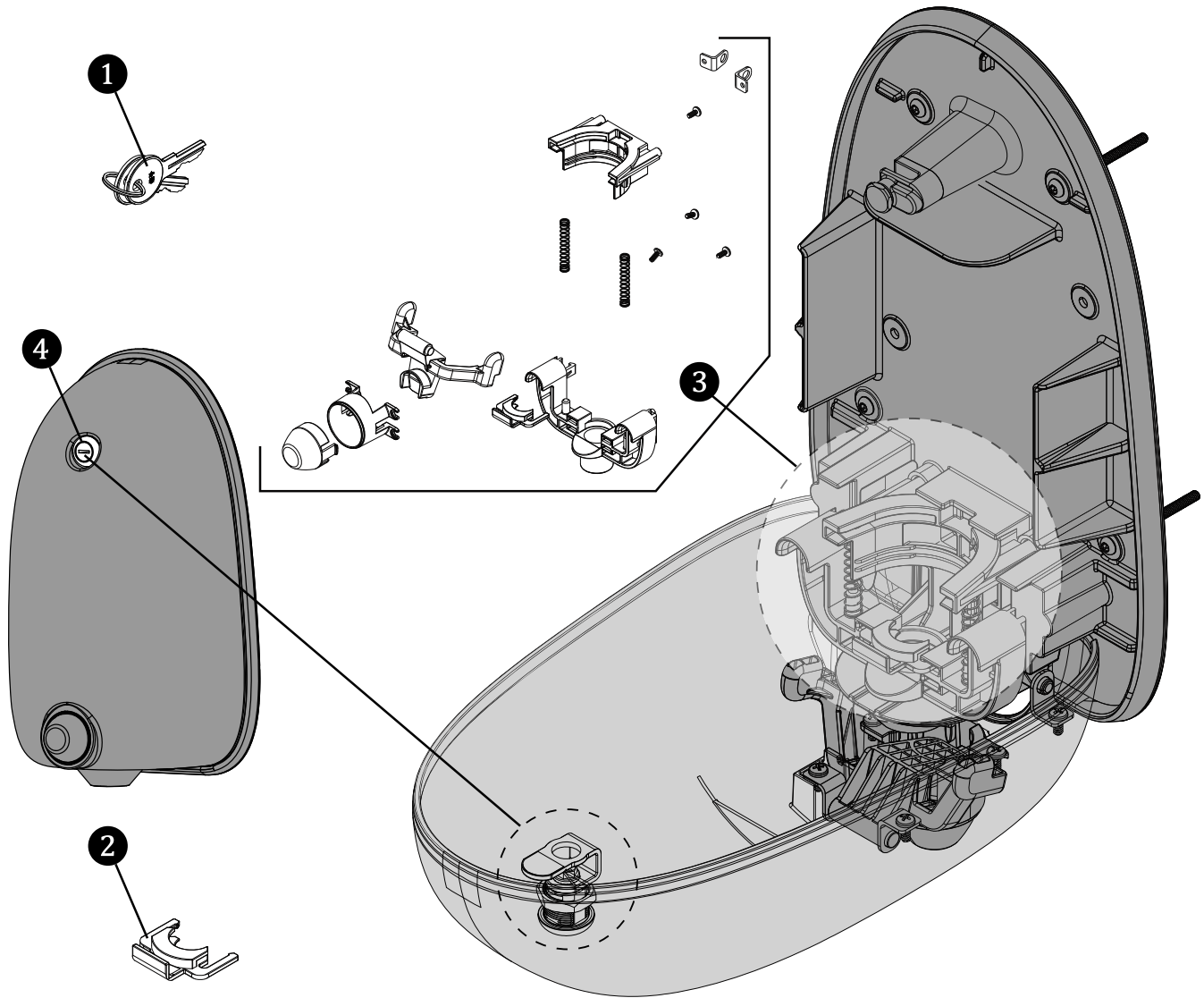

Item	Part No.	Description
1	RPG05-106408	REPLACEMENT KEYS FOR SD750 (TWO KEYS TO BE PROVIDED)
2	RPG44-106407	REPLACEMENT CLIP FOR SD750
3	RPG05-112145	FREQUENTLY USED REPAIR PART GROUP
4	G05-104598	ASSEMBLY KEY LOCK