

LIGATURE RESISTANT SINK AND TRAP COVER

#ET720/TC720

Installation, Maintenance & Operation Instructions

Our ET720 engineered solid surface sink is fashioned to meet the latest behavioral standards of ligature and aesthetic design. During development phases, we made countless design assessments to create a state-of-the-art ligature resistant lavatory that is aesthetically pleasing, functional and durable for many years of use. The sloped sides, backsplash, and trap cover deter ligature, and our mounting system is ideal for both retrofit into existing spaces or newly designed bathrooms.

The ET720 is designed to be paired with our TC720 ligature resistant trap cover, which incorporates an access door for repairs or inspection under the sink without having to remove the entire trap cover. The sink and interlocking companion trap cover are designed to support additional weight over designs with a stand-alone sink. The ET720 accepts all standard faucets as well as our patented BSP faucets.

We also include a ligature resistant drain, tamper resistant mounting hardware and a robust mounting plate in our sink kit for a complete installation package. The ET720 is available in a number of custom and standard popular colors.

Specifications

- ADA compliant.
- Anti-microbial coating.
- Solid surface construction.
- Supports 500 lbs.
- Ligature resistant drain.
- Stainless steel tamper resistant hardware.
- Accepts standard 4" centerset faucet.
- Sloped sides for ligature resistance.
- Custom colors and standard colors.
- ET720 conforms to CSA B45.5/IAPMO Z124 Plastic Plumbing Fixtures. TC720
- Trap cover includes removable access door for maintenance.



Important

- Be sure to read instructions thoroughly before beginning installation.
- Do not over-tighten any connections or damage may occur.
- **DANGER: Electric Shock Hazard**
Check location of Electrical wires inside the wall.
Disconnect the Power before installation.

Tools and Supplies

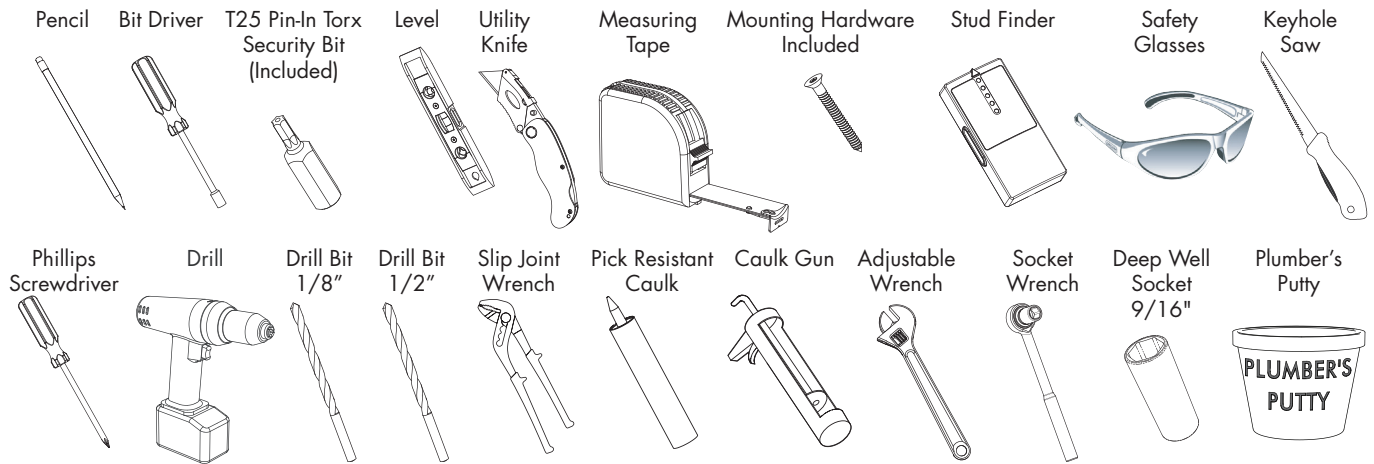

Care & Cleaning

Your new Product is designed for years of trouble-free performance. Keep it looking new by cleaning it periodically with a soft cloth and mild soap. The use of harsh chemicals and abrasives on any of the custom finish products may damage the finish and void the product warranty. Please be sure to only use approved cleaners.

Waiver & Disclaimer

This waiver-disclaimer is attached to and made a part of the written contract to purchase these products for use in psychiatric and correctional facilities. Such fixtures and products are purchased to reduce the risk of self-imposed death or injury to patients or clients in such facilities, but are NOT represented as able to prevent such death or injury.

Behavioral Safety Products, LLC ("BSP") as the seller and Speakman Company as the manufacturer of these products have not, and will not represent or warrant to the purchaser shown in this contract ("Purchaser") that its fixtures and products will prevent death or injury in any case whatsoever.

BSP and Speakman Company make no express or implied warranty with respect to the preventative quality of its products, but merely represents that the use of such products tends to reduce deaths and injuries by patients or clients who are subject to meticulous screening processes and diligent supervision on the part of the facility housing them.

Purchaser acknowledges the foregoing disclaimer and waives any and all claims against BSP and Speakman Company as to express or implied warranties of fitness for any purpose whatsoever.

Rough In Dimensions

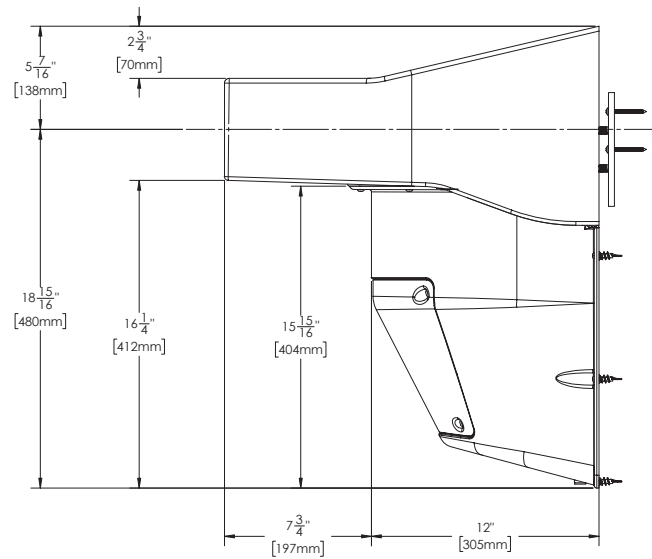
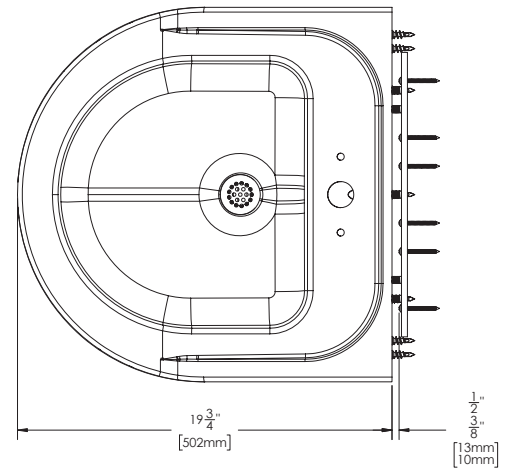
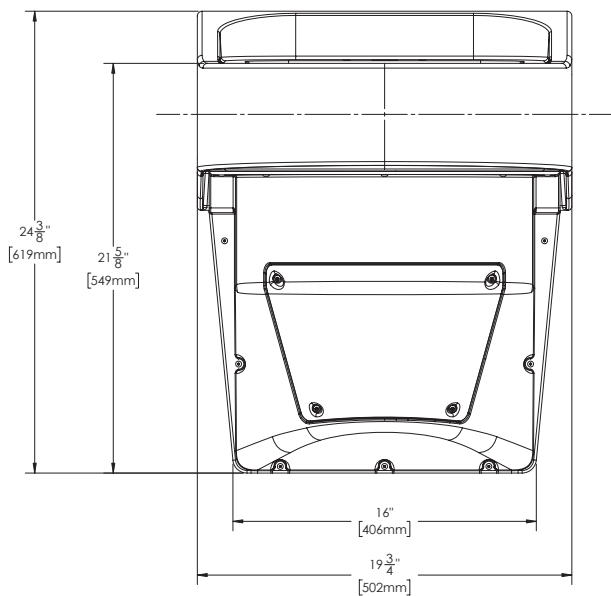

Rough In Dimensions

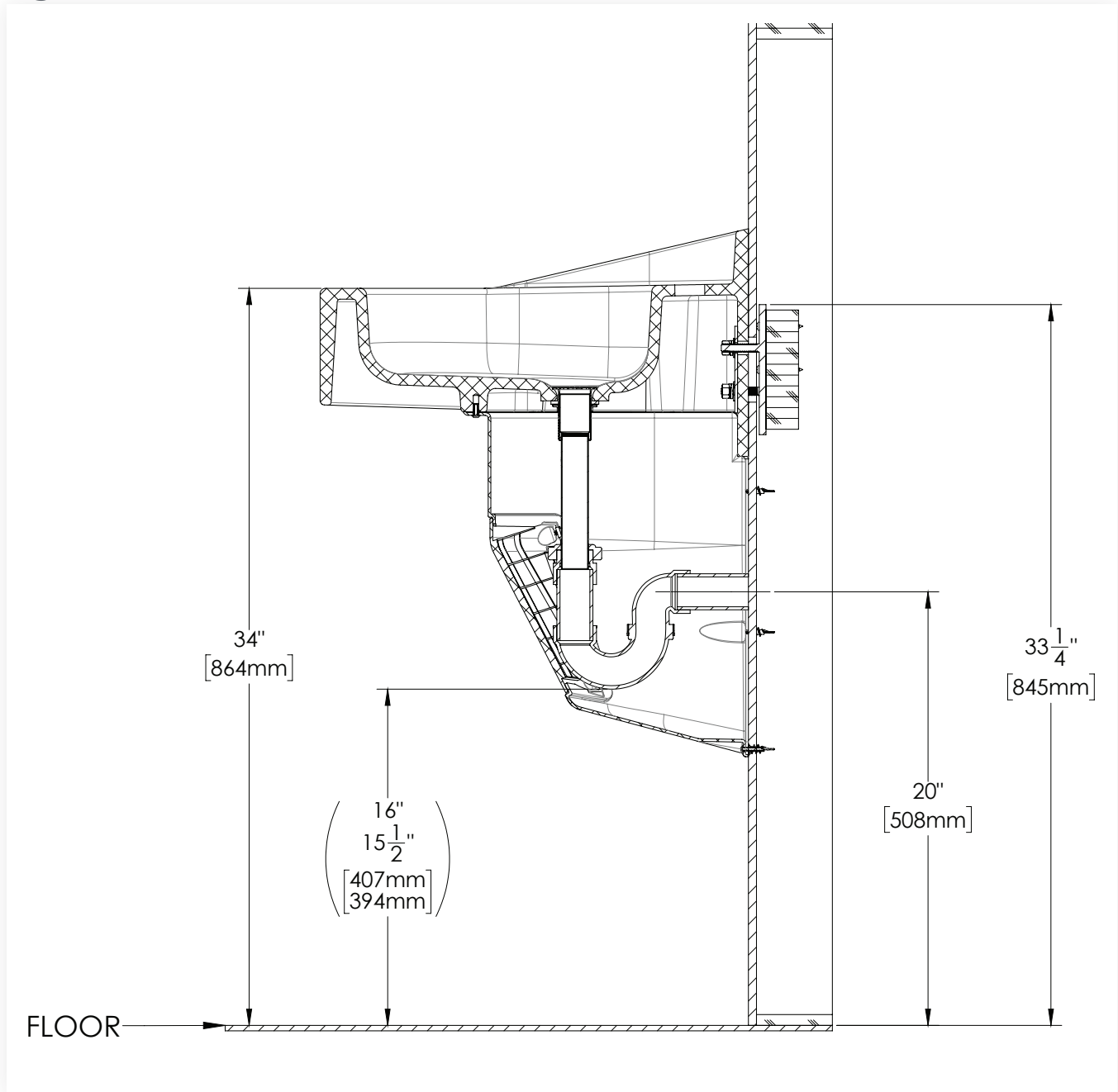

Installation Instructions

For Typical Install using Dry Wall as Finished Wall

1. ASSEMBLE MOUNTING PLATE TO CROSS BEAM

- Measure distance between adjoining vertical studs and cut 2" x 6" cross beam to length.
- Align top surface of Mounting Plate to top surface of Cross Beam. Once aligned, drill 1/8" pilot holes using the Mounting Plate as a guide (x10).
- Secure Mounting Plate to 2" x 6" Cross Beam by screwing included Mounting Screws into mounting holes. (x10).

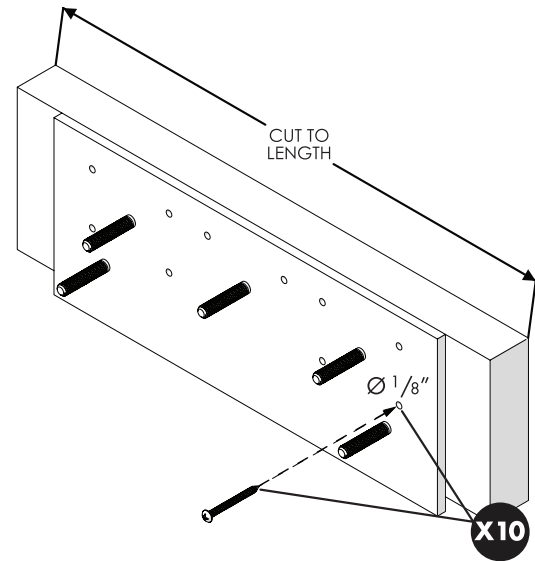
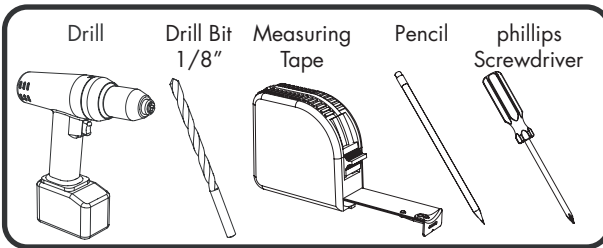

ASSEMBLE CROSS BEAM TO STUD

- Height of the Mounting Plate, measured from the floor to the top of the Plate, should be 33-1/4" **"A"**. **Note:** This will place the top of the sink 34" from the floor. See Rough-In on Page 4.

IMPORTANT: Position the 2" x 6" Cross Beam and Mounting Plate within the wall cavity. The front surface of the Mounting Plate should be recessed from the front surface of the vertical stud by 1/4" **"B"**. Use a level to ensure that the mounting plate is level and plumb.

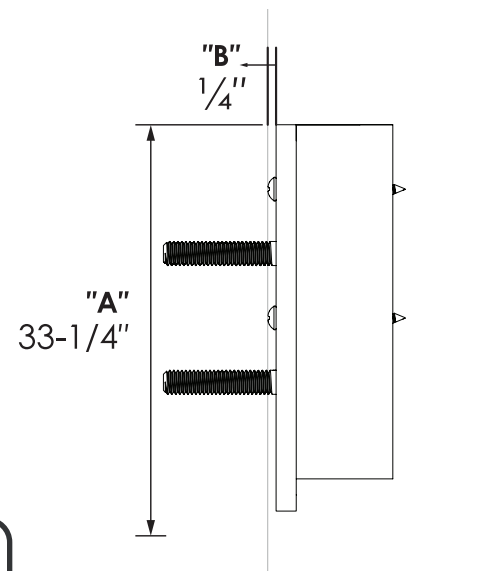

NOTE:

Heads of screws must not protrude beyond the finished wall surface.

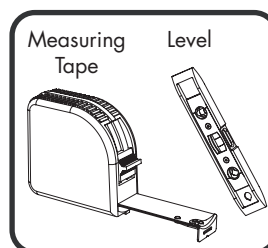

- Once rough-in location is established, assemble 2" x 6" Cross Beam to Vertical studs behind mounting wall. Orient the Mounting Plate as shown. Hardware for assembly to Vertical studs is not included. Recommend 3 mounting screws per side. (Pre-drilling pilot holes is recommended).

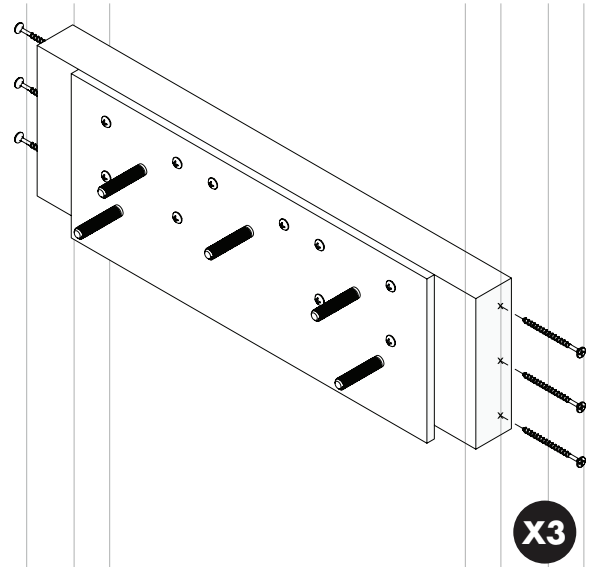
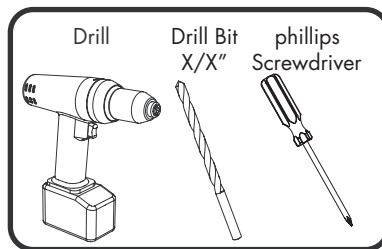

3. PREPARE DRYWALL

- Prepare drywall by cutting a 3" x 12" rectangular hole at the appropriate height or drill clearance holes for the Mounting Plate's threaded studs using a 1/2" Drill Bit.

IMPORTANT:

Complete wall construction and finish surfaces before continuing installation.

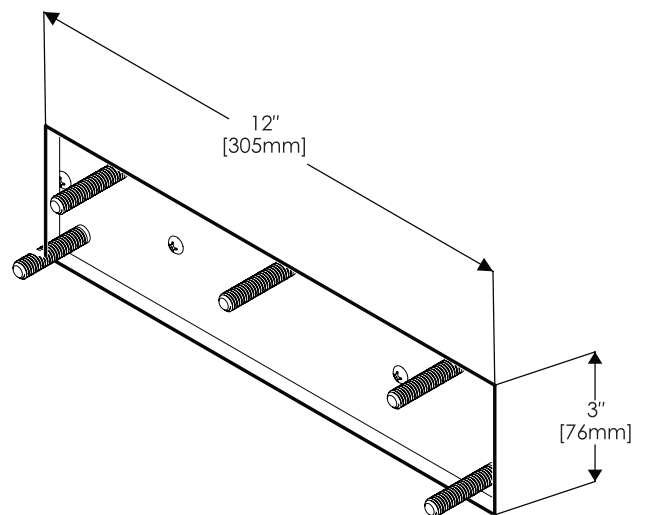
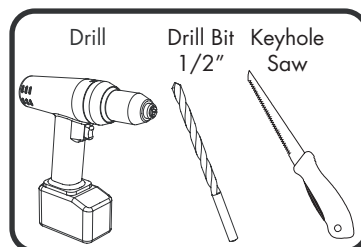

4. ASSEMBLE SINK TO WALL

- Position the Sink on to the Mounting Plate Studs against the wall. Hold the sink in place until secured with mounting hardware.
- Position supplied Cover Plate (1) over Mounting Plate Studs.

NOTE:

Two (2) people are recommended for this installation step.

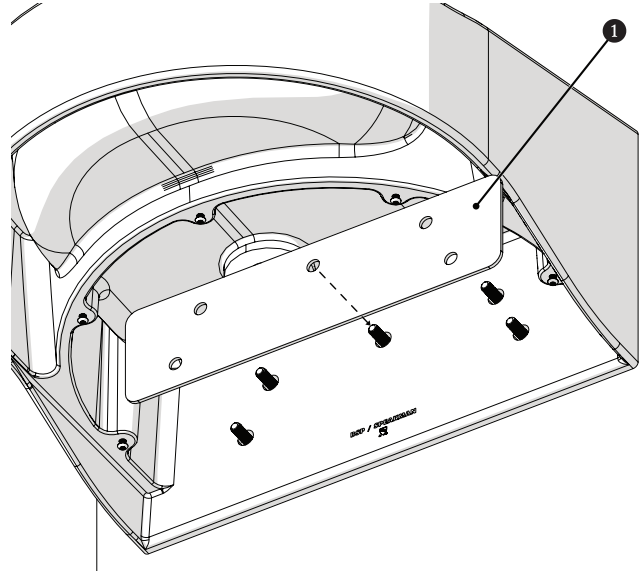

5. ASSEMBLE SINK TO WALL

- Install Flat Washers (1), and Lock Washers (2) on to each Mounting Stud. Secure with included Mounting Nuts (3). Snug into position.
- Using a level, check alignment and level the sink.
- Check for any significant gaps between the sink and the finished wall. Make adjustments as needed.
- Final Wrench tighten Mounting Nuts into position.
- Limit Torque to 75 in*lbs.

NOTE:

Two (2) people are recommended for this installation step.

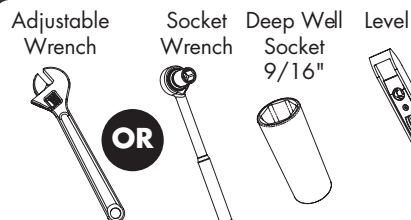
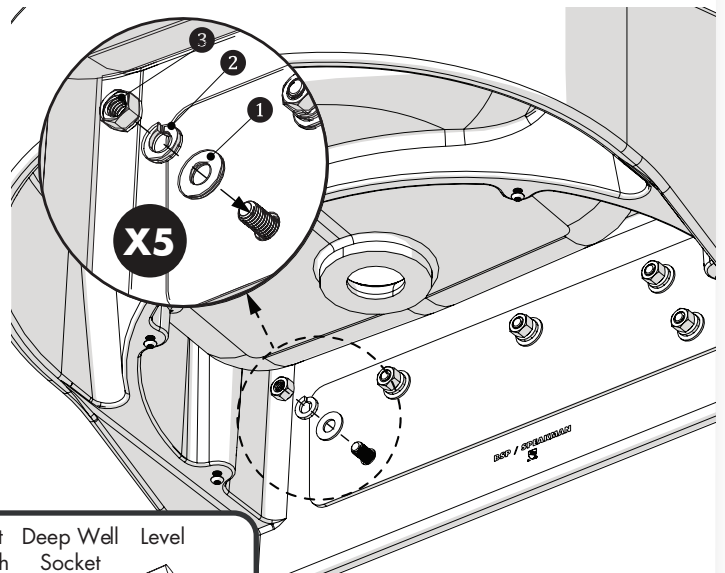

Drain Assembly

1. Remove Mounting Nut (1), Metal Washer (2), and Lower Sealing Washer (3) from Drain Assembly.

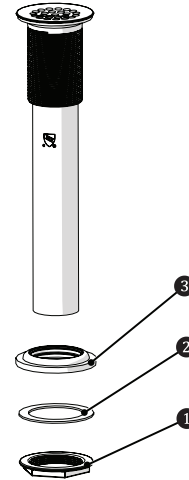

2. Apply included Upper Drain Seal (1) or Plumber's Putty to the underside of the Upper Flange. Insert Drain Assembly into drain hole of sink from above.

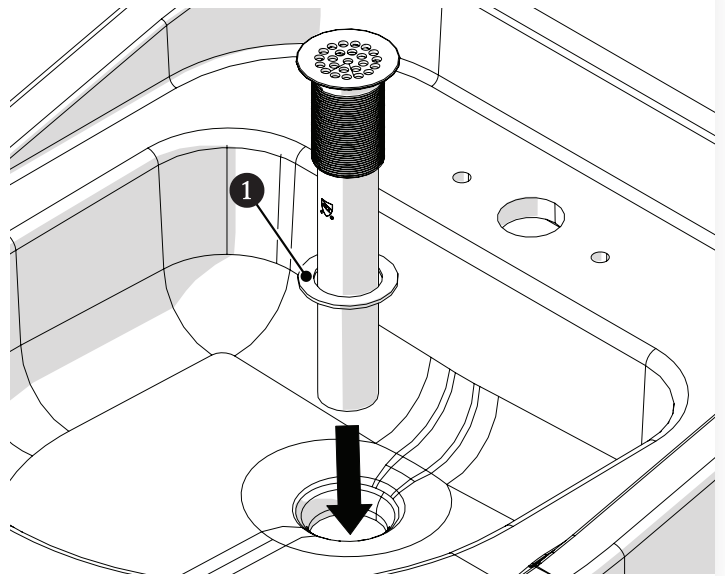

Drain Assembly

3. From below, install Lower Sealing Washer (raised protrusion facing up) (3), Metal Washer (2), and secure with Mounting Nut (1). Tighten with Slip Joint Pliers. Take care to not over-tighten connection.

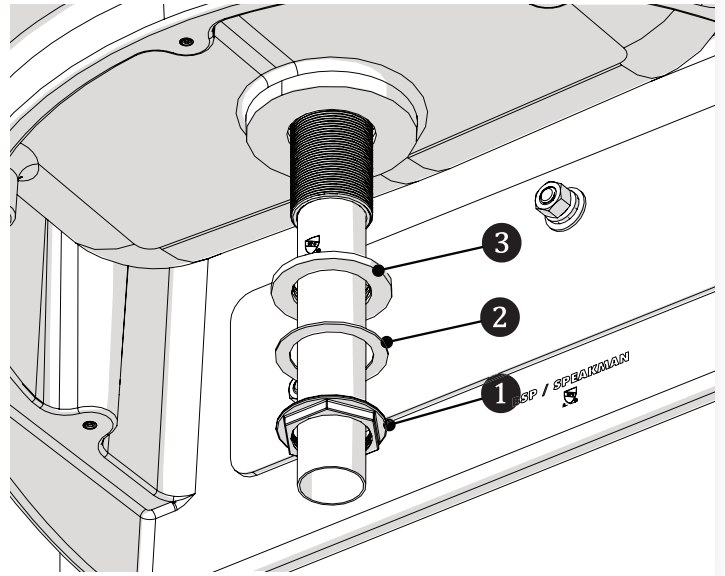
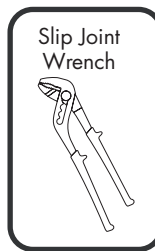

4. Assemble all remaining drain connections (not included) and hand tighten only at this time.

RECOMMENDED:

Install faucet to be used and complete all plumbing/electrical connections before continuing.

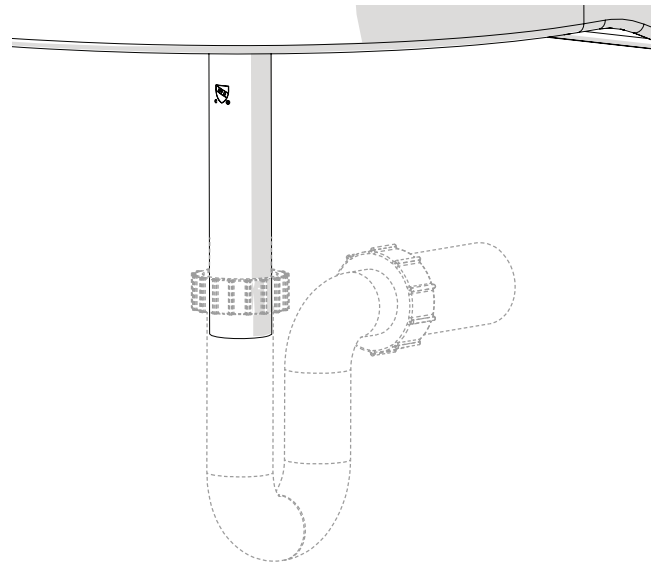

Trap Cover Installation

1. Remove tape securing P-Trap Access Panel and set aside. Place Trap Cover under the Sink and use the supplied #10-24 x 0.5" Screws to fasten the cover to the Sink using the supplied T25 Security Torx Driver (X5).

IMPORTANT:

Start with the Back screws (#1), followed by the Middle screws (#2), and finally the Center screw (#3).

IMPORTANT:

Take care not to damage the Sink's brass inserts. Limit torque to 20 in*lbs.

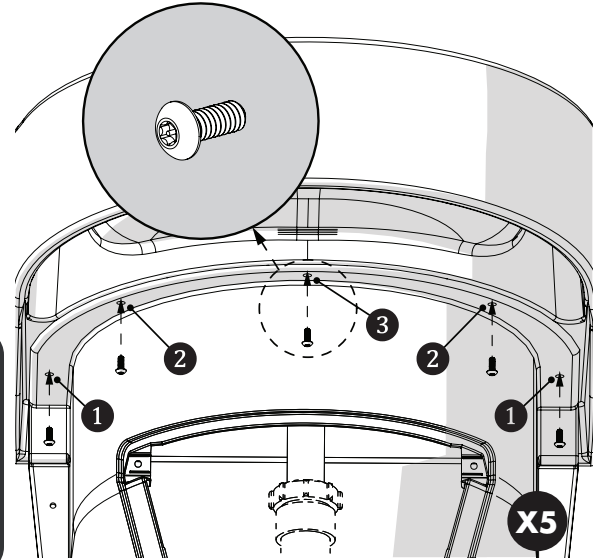
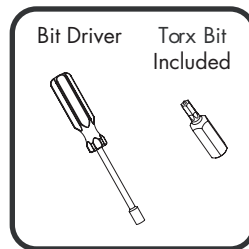

2. Use the indicated holes on the front of the Trap Cover as a template to mark locations and drill pilot holes for the Zinc Anchors (X7) using a 1/8" Drill Bit.

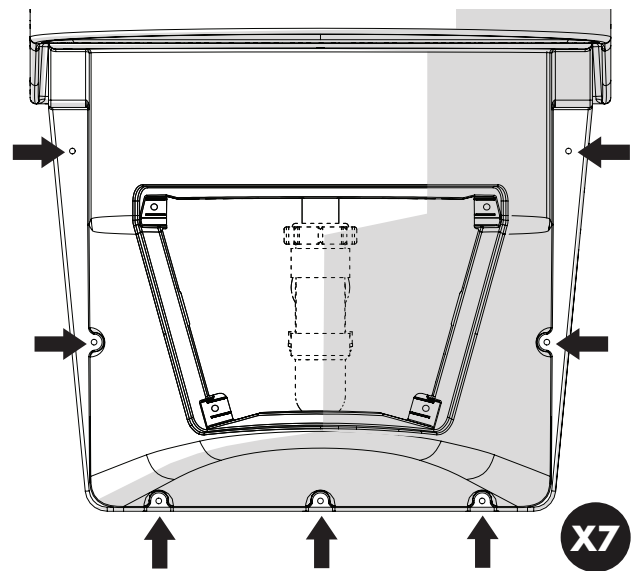
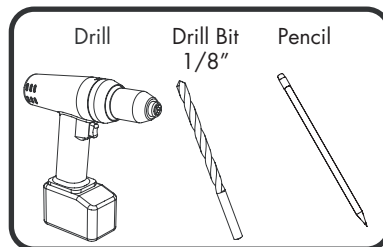

Trap Cover Installation

3. Remove the Trap Cover and install the supplied Zinc Anchors into the dry wall (X7).
 - Verify that all plumbing connections fit properly with the Trap Cover.
 - Final Wrench Tighten all plumbing connections.
 - Turn on water supplies, run water for 1 minute and inspect for leaks.

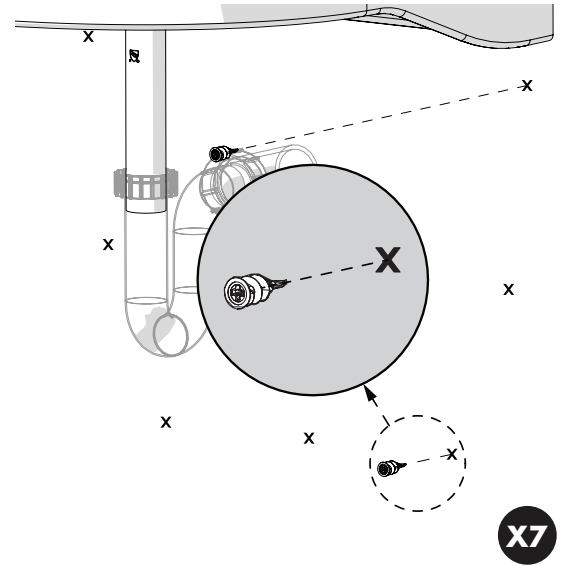
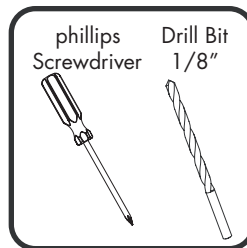

4. Re-install the Trap Cover under the Sink. Use the supplied #10-24 x 0.5" Screws to fasten the cover to the Sink using the supplied T25 Security Torx Driver (X5).

IMPORTANT:

Start with the Back screws (#1), followed by the Middle screws (#2), and finally the Center screw (#3).

IMPORTANT:

Take care not to damage the Sink's brass inserts. Limit torque to 20 in*lbs.

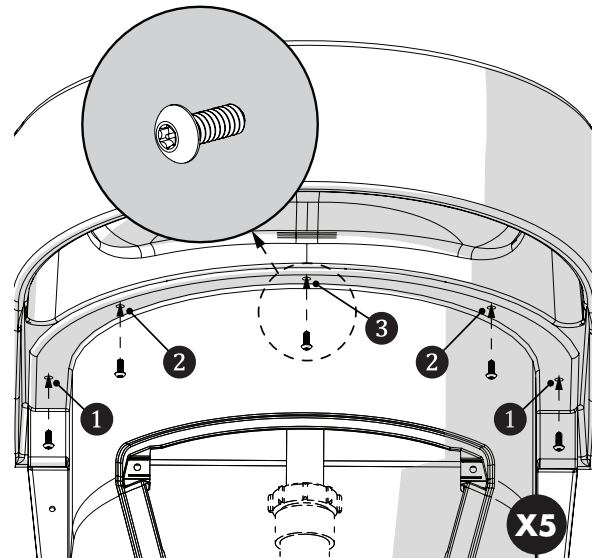
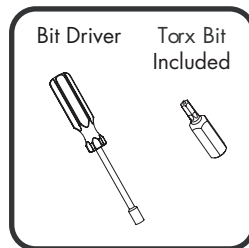

Trap Cover Installation

5. Install four (4) Threaded clips as shown. Secure Access Panel to the P-Trap cover using the included #10-24 x 0.5" Screws and the supplied T25 Security Torx Driver.

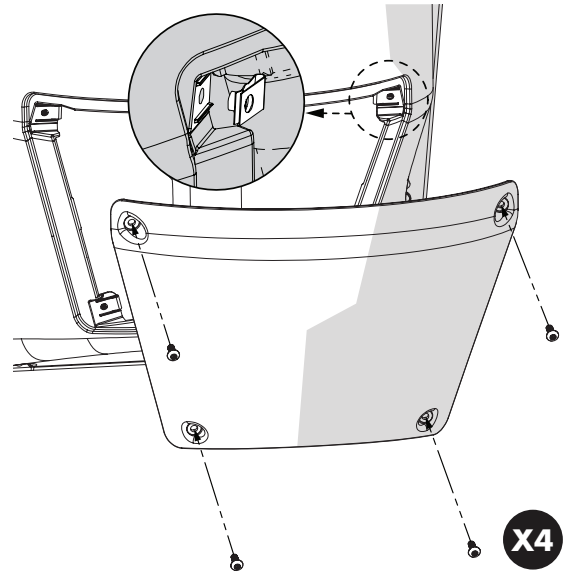
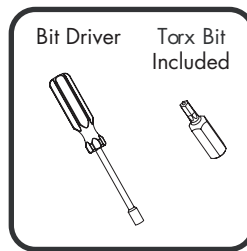

6. Install the #8 x 1" Screws into the installed Zinc Anchors using the supplied T15 Security Torx Driver securing the Trap Cover to the wall. (X7)
- Check for any significant gaps. Make adjustments as needed.
 - Apply pick free caulking material around the top 3 sides of the Sink and around the Trap Cover.

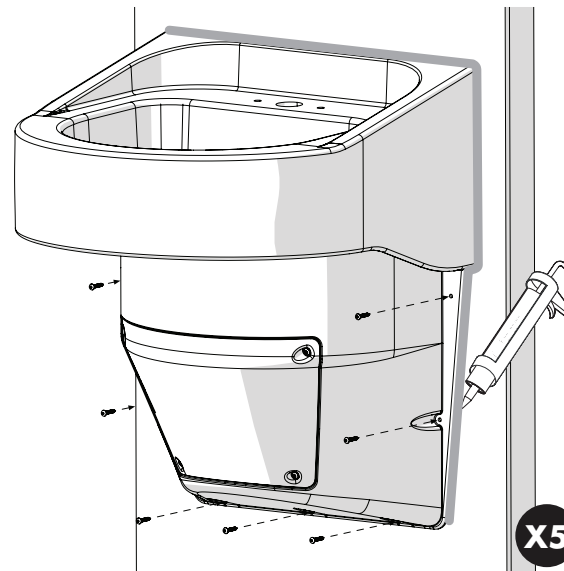
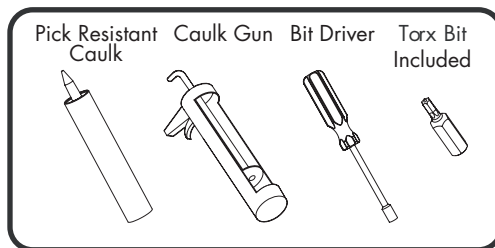

Repair / Replacement Parts

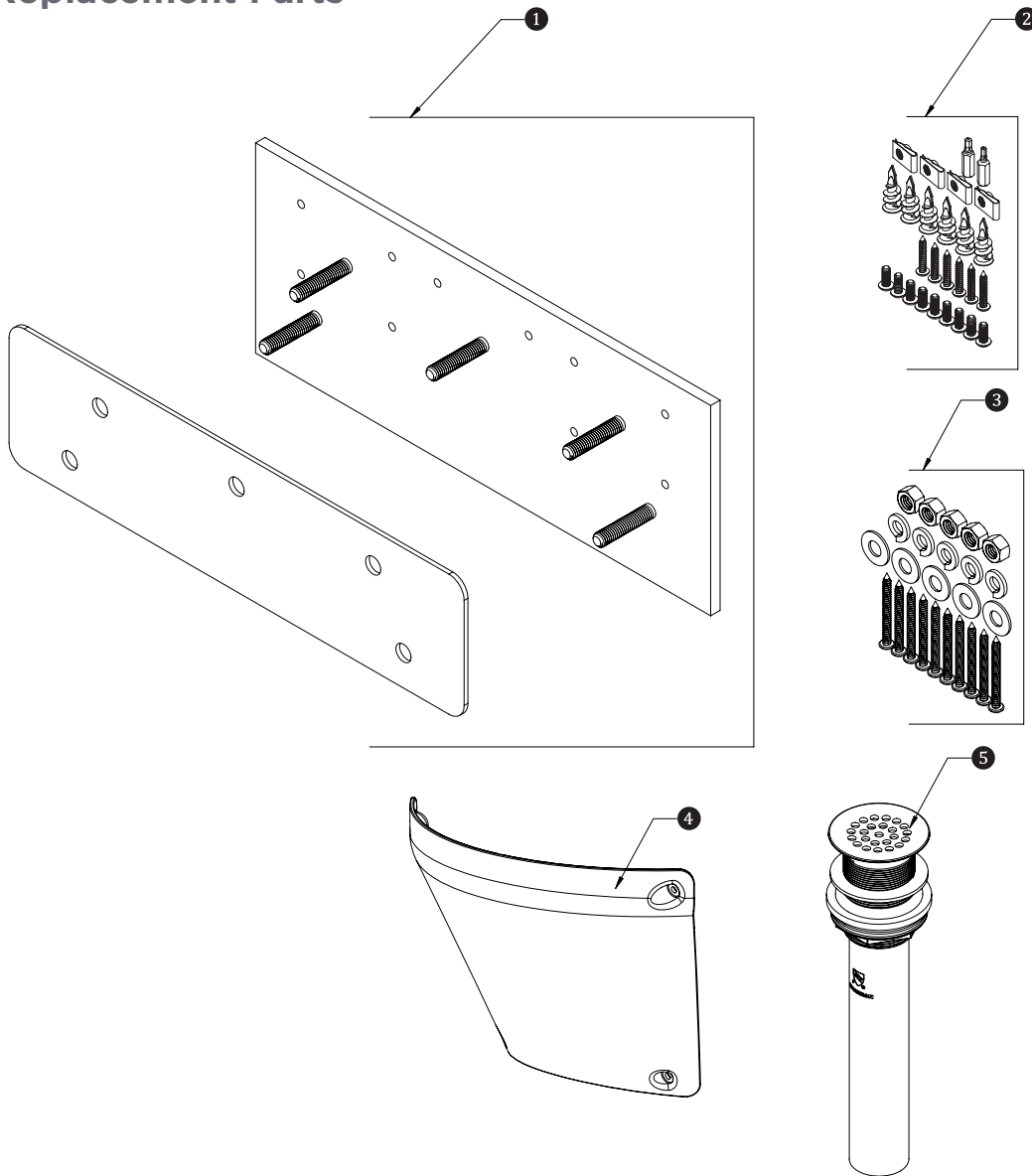

Item	Part No.	Description
1	RPG05-109416	SINK MOUNTING PLATES
2	RPG05-109417	TRAP COVER HARDWARE
3	RPG05-109418	SINK MOUNTING HARDWARE
4	RPG05-112485	REPAIR GROUP TRAP COVER
5	RPG05-112488	REPAIR GROUP, DRAIN